

# 3L Castle Crate

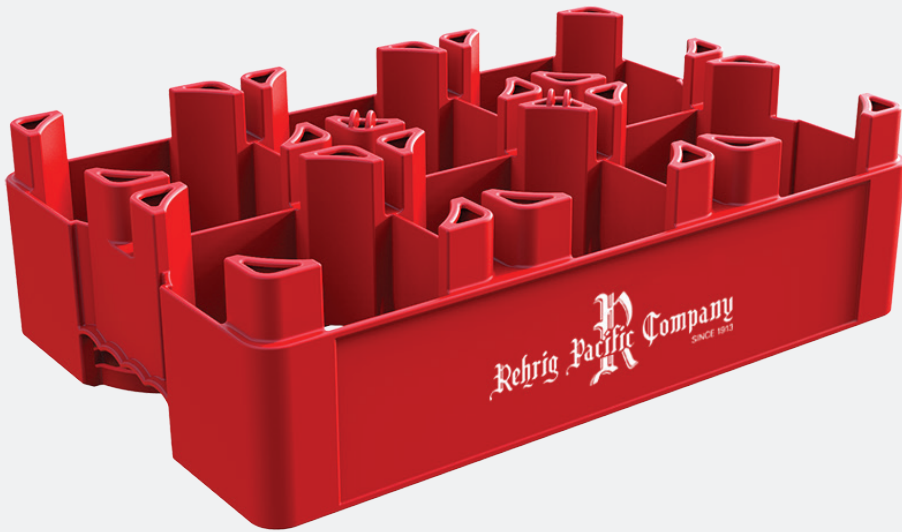

## Specifications

- Ergonomic, sturdy handles for ease with grasping, lifting and carrying
- Twist 'n slide bottom locates and locks crates and closures for stability in transit, yet releases easily for unloading
- Nested crates interlock for secure stacking in storage, return transit and unloading
- De-nest easily either manually or with automated de-nester
- Customized color and branding available to promote brand equity and asset management
- Optional bar code, RFID and proximity marketing enablement
- Large brand panel for increased brand awareness
- Tall columns increase contour bottle's stability in transit
- Highly nestable to reduce space needed for empty storage
- Anti-display feature so the package cannot be used for unintended retail displays (when flipped upside down)
- Engineered high density polyethylene (HDPE) material for enhanced strength and durability

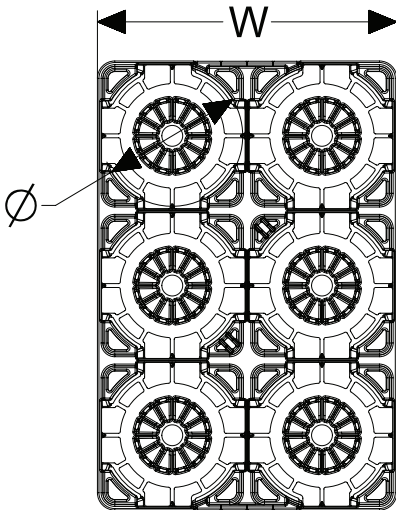

Specifications	IN/LB	MM/KG
Length (L)	16.1	410
Width (W)	10.7	273
Height (H)	4.8	122
Pocket Diameter (ø)	5.1	130
Nesting Increment	3.5	89.0
Weight	2.34	1.06

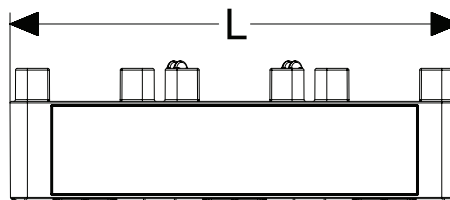
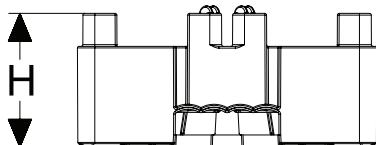

**Corporate Headquarters**  
 4010 East 26th St., Los Angeles, CA 90058  
 (800) 421-6244 • (323) 262-5145

**Locations**  
 Los Angeles, CA • Orlando, FL • Atlanta, GA • De Soto, KS  
 Erie, PA • Dallas, TX • Kenosha, WI • Quebec, Canada  
 Querétaro, Qro., Mexico

**Web:** [www.rehrigpacific.com](http://www.rehrigpacific.com)



A FAMILY TRADITION OF GROWTH, SERVICE AND INNOVATION